

LOC	QTY	P	F	ZONE	LTR	DESCRIPTION	DATE	APPD
G	14					REVISED & REDRAWN PER 0720-0040-93	3-29-93	1 st DAP
						REACTIVATED 53836-1 PER 0720-6018-92		

METRIOR
 DIMENSIONS LISTED IN MM [INCHES]

AMP WIRE RANGE	UL E13288 Listed
12-10 AWG SOLID OR STRANDED	12-10 AWG STRANDED
SB LR7189 Certified	MILITARY P/N AND CLASS
12-10 AWG SOLID OR STRANDED	NOT APPLICABLE

△ STAMP 10S AMP 12-10* APPROX AS SHOWN
 10S INDICATES STUD SIZE

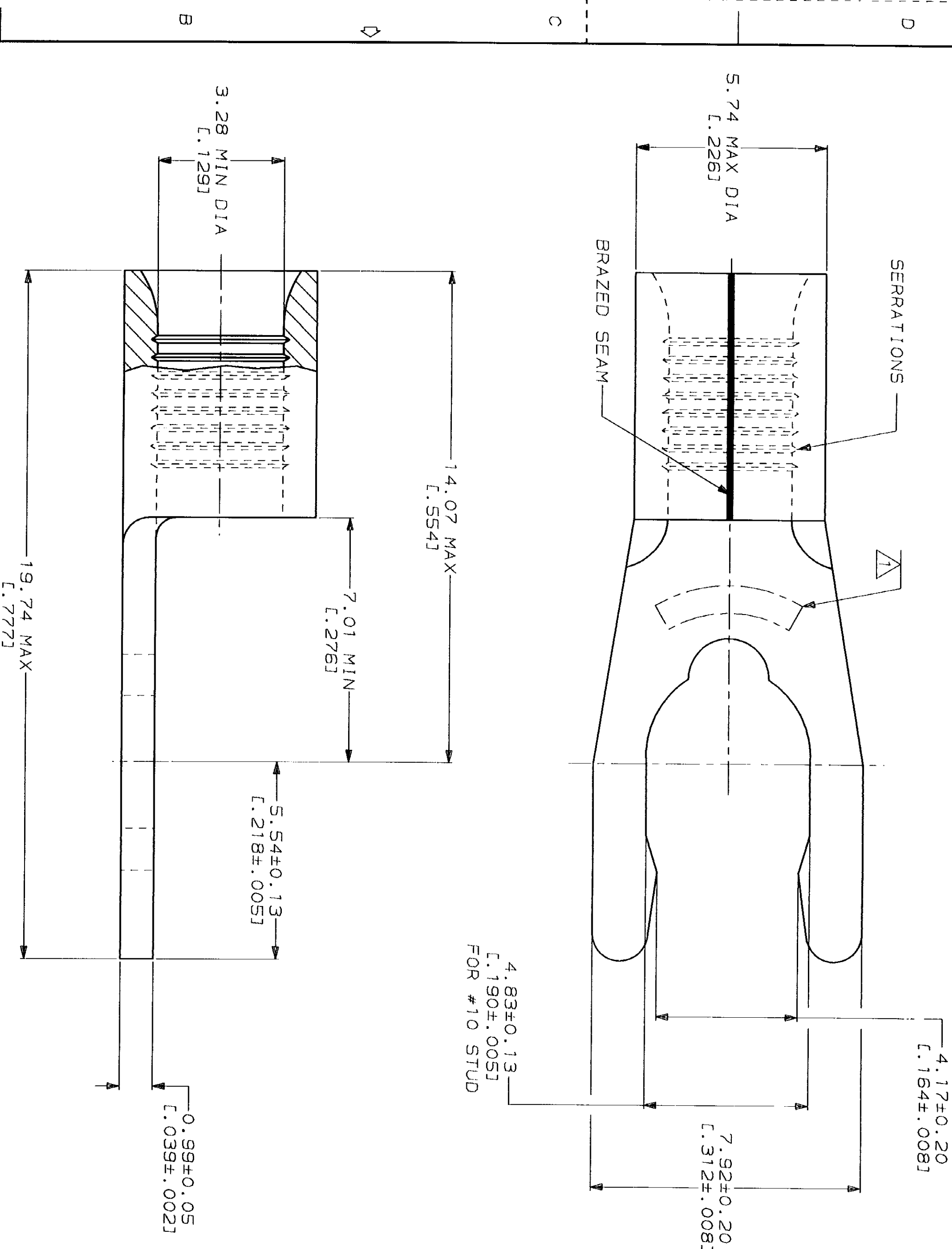

AMP INCORPORATED CUSTOMER SERVICE SYSTEMS		MAX RECOMMENDED OPERATING TEMPERATURE: 170°C MAX		DO NOT SCALE PRINT. UNLESS SPECIFIED DIMENSIONS IN MILLIMETERS. TOLERANCES ON: 2 PLC DEC # - 3 PLC DEC # - ANGLES # -	
FOR ADDITIONAL PRODUCT INFORMATION OR COPIES OF DRAWINGS AND TECHNICAL DOCUMENTS		PRODUCT INFORMATION CENTER 1-800-522-6752		DR 3-29-93 TA BRINKMAN	
FOR APPLICATION TOOLING INFORMATION		TOOLING ASSISTANCE CENTER 1-800-722-1111		CHK 3-29-93 DA PATTERSON	
FOR ORDER ENTRY		1-800-526-5142		APPD 3-29-93 DE MILLER	
VOLTAGE RATING: NOT APPLICABLE		WIRE CROSS SECTIONAL AREA RANGE: 2.62-6.64mm ² [5, 180-13, 100] CIR MILS SOLID OR STRANDED		APPD 3-29-93 JL MECKLEY	
FINISH: TIN PLATE		0.00254 [L.000100] MIN THK PER MIL-T-10727		DR 3-29-93 TA BRINKMAN	
APPLICATION SPEC		WEIGHT		CHK 3-29-93 DA PATTERSON	
SIZE: CAGE CODE 00779 DRAWING NO G=53836		SCALE: 10:1		APPD 3-29-93 DE MILLER	
TERMINAL, SHORT SPRING SPADE, SOLISTRAND™		ON TAPE		APPD 3-29-93 JL MECKLEY	
AMP Incorporated Harrisburg, PA 17105-3508		LOOSE PIECE		APPD 3-29-93 JL MECKLEY	
53836		PACKAGING TYPE		APPD 3-29-93 JL MECKLEY	
53836-1		PART NO		APPD 3-29-93 JL MECKLEY	
1 OF 1		QUANTITY		APPD 3-29-93 JL MECKLEY	
1		2500		APPD 3-29-93 JL MECKLEY	